

**Beth Hulse**

---

**From:** Beth Hulse  
**Sent:** Friday, January 17, 2014 10:04 AM  
**To:** kalexander@salemnc.us  
**Cc:** Russell Price; Beth Hulse  
**Subject:** Capital Project Sales Tax Commission - Presentations

Good Morning;

The Capital Project Sales Tax Commission at their meeting last night established a schedule to meet with entities regarding their proposed project in order to obtain additional information and have a Q&A session.

The Commission invites you to attend their February 19, 2014 meeting at 6:30 p.m. to present your projects to the commission and the public. [Project #10 – Northern Economic Development at 6:30 p.m.; #11 – Recreation & Senior Center at 7:15 p.m.] If you are unable to attend or do not wish to attend, please advise the staff liaison no later than twenty four hours prior to the meeting.

The Commission also established the following guidelines for presentations:

- 20 minute presentation maximum time + Q&A period
- Presentations will be scheduled 45 minutes apart to allow for a breaks and set time
- No more than two speakers will be permitted for the presentation and Q&A period
- Handouts for Commission:
  - Do not provide any material that was submitted with your original questionnaire – all Commission members received this material.
  - If you wish the staff liaison to provide copies to the Commission they must be provided via email no later than twenty four hours prior to the meeting.
  - If you wish to distribute material at the meeting you will be required to provide 7 copies of each handout and the handouts must be 3-hole punched.

If you have any questions/concerns, please feel free to contact the staff liaison [Beth Hulse, 718-1023, [bhulse@oconeesc.com](mailto:bhulse@oconeesc.com)] who will be coordinating these presentations for the Commission.

Sincerely,  
Russell Price  
Capital Project Sales Tax Commission, Chairman

---

**Elizabeth G. Hulse**  
**Clerk to County Council**  
Oconee County Administrative Offices  
415 South Pine Street  
Walhalla, SC 29691  
864-718-1023  
864-718-1024 [fax]  
[bhulse@oconeesc.com](mailto:bhulse@oconeesc.com)  
[www.oconeesc.com/council](http://www.oconeesc.com/council)

CONFIDENTIALITY NOTICE: This e-mail message, including any attachments, is for the sole use of the intended recipient(s) and may contain confidential, proprietary, and/or privileged information protected by law.

## Beth Hulse

---

**From:** Beth Hulse  
**Sent:** Friday, January 17, 2014 10:04 AM  
**To:** kalexander@sailemnc.us  
**Cc:** Russell Price; Beth Hulse  
**Subject:** Capital Project Sales Tax Commission - Presentations

Good Morning;

The Capital Project Sales Tax Commission at their meeting last night established a schedule to meet with entities regarding their proposed project in order to obtain additional information and have a Q&A session.

The Commission invites you to attend their **February 19, 2014** meeting at 6:30 p.m. to present your projects to the commission and the public. [Project #10 – Northern Economic Development at 6:30 p.m.; #11 – Recreation & Senior Center at 7:15 p.m.] If you are unable to attend or do not wish to attend, please advise the staff liaison no later than twenty four hours prior to the meeting.

The Commission also established the following guidelines for presentations:

- 20 minute presentation maximum time + Q&A period
- Presentations will be scheduled 45 minutes apart to allow for a breaks and set time
- No more than two speakers will be permitted for the presentation and Q&A period
- Handouts for Commission:
  - Do not provide any material that was submitted with your original questionnaire – all Commission members received this material.
  - If you wish the staff liaison to provide copies to the Commission they must be provided via email no later than twenty four hours prior to the meeting.
  - If you wish to distribute material at the meeting you will be required to provide 7 copies of each handout and the handouts must be 3-hole punched.

If you have any questions/concerns, please feel free to contact the staff liaison [Beth Hulse, 718-1023, [bhulse@oconeesc.com](mailto:bhulse@oconeesc.com)] who will be coordinating these presentations for the Commission.

Sincerely,  
Russell Price  
Capital Project Sales Tax Commission, Chairman

\*\*\*\*\*  
**Elizabeth G. Hulse**  
**Clerk to County Council**  
Oconee County Administrative Offices  
415 South Pine Street  
Walhalla, SC 29691  
864-718-1023  
864-718-1024 [fax]  
[bhulse@oconeesc.com](mailto:bhulse@oconeesc.com)  
[www.oconeesc.com/council](http://www.oconeesc.com/council)

**CONFIDENTIALITY NOTICE:** This e-mail message, including any attachments, is for the sole use of the intended recipient(s) and may contain confidential, proprietary, and/or privileged information protected by law.

**Beth Hulse**

---

**From:** Beth Hulse  
**Sent:** Friday, January 17, 2014 10:06 AM  
**To:** 'walhalawaterdep@bellsouth.net'  
**Cc:** Russell Price; Beth Hulse  
**Subject:** Capital Project Sales Tax Commission - Presentation

Good Morning;

The Capital Project Sales Tax Commission at their meeting last night established a schedule to meet with entities regarding their proposed project in order to obtain additional information and have a Q&A session.

The Commission invites you to attend their **February 19, 2014 meeting at 8:00 p.m.** to present your project to the commission and the public. If you are unable to attend or do not wish to attend, please advise the staff liaison no later than twenty four hours prior to the meeting.

The Commission also established the following guidelines for presentations:

- 20 minute presentation maximum time + Q&A period
- Presentations will be scheduled 45 minutes apart to allow for a breaks and set time
- No more than two speakers will be permitted for the presentation and Q&A period
- Handouts for Commission:
  - Do not provide any material that was submitted with your original questionnaire – all Commission members received this material.
  - If you wish the staff liaison to provide copies to the Commission they must be provided via email no later than twenty four hours prior to the meeting.
  - If you wish to distribute material at the meeting you will be required to provide 7 copies of each handout and the handouts must be 3-hole punched.

If you have any questions/concerns, please feel free to contact the staff liaison [Beth Hulse, 718-1023, [bhulse@oconeesc.com](mailto:bhulse@oconeesc.com)] who will be coordinating these presentations for the Commission.

Sincerely,  
Russell Price  
Capital Project Sales Tax Commission, Chairman

\*\*\*\*\*  
**Elizabeth G. Hulse**  
**Clerk to County Council**  
Oconee County Administrative Offices  
415 South Pine Street  
Walhalla, SC 29691  
864-718-1023  
864-718-1024 [fax]  
[bhulse@oconeesc.com](mailto:bhulse@oconeesc.com)  
[www.oconeesc.com/ccl/ncl/](http://www.oconeesc.com/ccl/ncl/)

CONFIDENTIALITY NOTICE: This e-mail message, including any attachments, is for the sole use of the intended recipient(s) and may contain confidential, proprietary, and/or privileged information protected by law. If you are not the intended recipient, you may not read, use, copy, or distribute this e-mail message or its



OCONEE COUNTY  
CAPITAL PROJECT SALES TAX COMMISSION

Council Chambers, Oconee County Administrative Offices  
415 South Pine Street, Walhalla, SC

## PROJECT SUBMITTAL FORM

Due no later than January 15, 2014.

The Capital Project Sales Tax Commission has established a minimum project value for submission in the amount of \$250,000.

1. PROJECT NAME: NORTHERN ECONOMIC DEVELOPMENT
2. Entity Name: TOWN OF SALEM
3. \*\*Project Description: Develop the basic infrastructure and facilities needed to support community and economic development.
4. Estimated Project Cost: \$ 1,300,000.00
5. Funding for this project from other source[s]: (\$ 250,000.00 )  
Town match
6. Net Amount Applied For: \$1,150,000.00
7. \*\*Benefits of Project: This project could create 175 temporary construction jobs over the next 2 years and 85 permanent jobs over the next 5 years for citizens in the Salem area. The availability of nearby jobs greatly enhances the standard of living for Salem families. While this is an additional benefit, the waterline will also provide greatly improved fire safety for residents and the new businesses of Salem.
8. Entity Contact Information:  
Name: Town Of Salem  
Telephone Number[s]: 864-944-2819  
Email: kalexander@salemnc.us
9. Submitted by [name/title]: Kim Alexander Clerk
10. Other Comments/Notes:

\*\* You may provide supporting material with this form to include but not limited to plans, studies, maps, brochures, artist renderings, cost estimates, photographs, etc. Submitted material should not exceed 20 pages [in addition to this form].

Please be advised that the Commission may for the Commission's discretion schedule a meeting with the Entity submitting the project to obtain additional information.

Questions regarding this process and/or this form should be directed to [hhulse@oconeesc.com](mailto:hhulse@oconeesc.com).

COMMISSION USE

CPSTC ID# 10

Date Rec'd: 1-15-14

Recommended: Y / N



# Oconee County, South Carolina

## Capital Project Sales Tax Commission

### Project Criteria Questionnaire

Project Name/Description: **OCONEE NORTH ECONOMIC DEVELOPMENT**

The purpose of this document is to assist the Capital Project Sales Tax Commission (CPSTC) in understanding your proposed capital projects.

#### **Please provide a brief summary of the overall project below:**

This project will help with the development of the business corridor in the northern part of Oconee County. This project will provide many benefits, along with providing critical infrastructure for several schools and residential boarding facilities. In November 2012 unemployment in Oconee County was 8.6%, as compared to SC at 8.3% and the US rate of 7.7% for the same month; the region traditionally is higher than State unemployment. The rural character/isolation creates obstacles for many of the citizens of Salem; jobs are few in the immediate area; and Salem residents on average travel 24.4 minutes to work in Seneca/Clemson area (one-way travel time). Salem is ripe for growth with the ecotourism draw of the nearby lakes, waterfalls, forests and parks, and has seen great residential growth nearby with the number of homes built or purchased near Lakes Keowee and Jocassee. Over the last two years, Salem has been approached by eight business persons, including hoteliers, grocery stores and other retailers wanting to build along Highway 11, however, when Salem cannot provide them needed infrastructure the construction plans cease. The Town, seeking to grow business opportunities and jobs for its citizens plan to obtain funding to leverage with its infrastructure fund (local funds) to construct the first of two phases of water infrastructure along this corridor.

The purpose of this questionnaire is to gather additional information regarding the project. Please provide as much information as you wish for each question. The Commission is not requesting that you provide any information not already in your possession regarding this project.

#### **SUBMISSION OF THIS FORM:**

Please return this form to the staff liaison either via email or US Mail:

[bhulse@oconeesc.com](mailto:bhulse@oconeesc.com)

Clerk to Council  
Oconee County Administrative Offices  
415 South Pine Street  
Walhalla, SC 29691

**Please be advised that individual Commission members will not accept questionnaires.**

**1. Does the proposed project directly address a health and/or safety needs in Oconee County?**

YES  NO  N/A

If YES provide the following information in the space indicated below.

- a. What is the need most directly addressed by the proposed project, and how will it address the issue?
- b. Are there other possible alternatives to proposed project?
- c. Have other solutions been proposed/attempted?
- d. What secondary benefits to health and safety will result from the proposed project?

Click on gray area to insert response -box will expand as needed:

The basic infrastructure needs for many rural areas in Oconee County are the same however the Town of Salem is looking to the future and preparing for the growth as the County has placed new substations in the Northern area fire service in the Tamasee area is still difficult due to the issue of fire hydrants and having to shuttle water the new storage facility and water supply loop will help with the safety of the residents in Oconee County.

**2. Does the proposed project address a federal/state mandate?**

YES  NO  N/A

If YES provide the following information in the space indicated below.

- a. What agency is mandating the project (note specific section of law/regulation)?
- b. Has the project been reviewed by an attorney, and if so who?
- c. Are there other possible alternatives to the proposed project?
- d. Is there a deadline to meet the mandate, and is this a recurring requirement? If so, what is the anticipated length of time the proposed project will remain in compliance?

Click on gray area to insert response -box will expand as needed:

**3. Is the proposed project consistent with adopted strategic plans for either the county or one or more of the municipalities?**

YES \_\_\_\_\_ NO  N/A \_\_\_\_\_

If YES provide the following information in the space indicated below.

- What strategic plans reference the proposed project (note any timelines, responsible parties, etc.)?
- What agency sponsored the strategic plan?
- How was the plan developed?
- Has the plan been adopted/endorsed by County Council, City Council or other governing bodies?

Click on gray area to insert response -box will expand as needed:

**4. Does the proposed project implement the recommendations of a previous study?**

YES  NO \_\_\_\_\_ N/A \_\_\_\_\_

If YES provide the following information in the space indicated below.

- What agency sponsored the study (note the source of any funding)?
- What was the purpose of the study, and when was it performed?
- What factors considered in the study have changed since the work was done?
- Have the results of the study been presented to County Council?

Click on gray area to insert response -box will expand as needed:

The County had a fire service study done and this will assist in helping with better service for these Oconee Residents.

**5. Has the proposed project been included in previous Capital Improvement Plans for the County or another organization?**

YES \_\_\_\_\_ NO  N/A \_\_\_\_\_

If YES provide the following information in the space indicated below.

- a. When was the project first proposed?
- b. What was the original proposed date of construction/acquisition/implementation?
- c. Has any other agency also included the proposed project (or significant portion of) on their capital improvement plan?

*Click on gray area to insert response -box will expand as needed;*

**6. Will the proposed project result in the creation of (or retention of) jobs?**

YES  NO \_\_\_\_\_ N/A \_\_\_\_\_

If YES provide the following information in the space indicated below.

- a. How many jobs will be created?
- b. How many jobs will be retained that would otherwise be lost without the proposed project?
- c. What types of jobs?
- d. What is that anticipated pay range of the jobs?
- e. Are there other known job-related benefits associated with the proposed project?

*Click on gray area to insert response -box will expand as needed;*

Businesses that will be served by this project is 12

260 Jobs created \_\_\_\_\_

85 Jobs retained \_\_\_\_\_



**7. Will the proposed project facilitate development that directly enhances revenues through taxes or fees?**

YES  NO  N/A

If **YES** provide the following information in the space indicated below.

- What sources of increased revenues (taxes, fees, etc.) are anticipated to stem from the proposed project?
- What is the anticipated annual impact on each revenue source?
- Are there other possible enhancements to revenues that may be associated with the proposed project?

Click on gray area to insert response -box will expand as needed:

This project could create 175 temporary construction jobs over the next 2 years and 85 permanent jobs over the next 5 years for citizens in the Salem area. The availability of nearby jobs greatly enhances the standard of living for Salem families. While this is an additional benefit, the waterline will also provide greatly improved fire safety for residents and the new businesses of Salem.

**8. Will the proposed project enhance the County's image, thereby attracting potential investors?**

YES  NO  N/A

If **YES** provide the following information in the space indicated below.

- How will the proposed project be viewed by the 'average' citizen?
- How 'visible' will the proposed project (or its benefits) be?
- What type(s) of, and how much, private investment is the proposed project anticipated to attract?
- What level and type of promoting will be necessary to achieve the proposed project's maximum potential in attracting investment?

Click on gray area to insert response -box will expand as needed:

Businesses that will be served by this project is 12

**9. Will the proposed project help prevent the loss of jobs and/or revenue (other than any discussed above in this section) from Oconee County?**

YES  NO  N/A

If YES provide the following information in the space indicated below.

- a. What types of jobs/revenue are subject to loss without the proposed project?
- b. Has a project similar to the one proposed been completed in the county/jurisdiction to which the jobs/revenue will potentially be lost? If so, describe.
- c. Are there known alternatives to the proposed project that may effectively save the jobs/revenue?

Click on gray area to insert response -box will expand as needed:

**10. Will the proposed project facilitate acquisition of grants and/or other outside funding?**

YES  NO  N/A

If YES provide the following information in the space indicated below.

- a. What types of grants and/or other outside funding sources are expected to be made available by construction/acquisition of the proposed project?
- b. Have other jurisdictions successfully leveraged such funds with similar projects? If so, provide a brief overview.

Click on gray area to insert response -box will expand as needed:

**11. Will the project be economically sustainable?**

**YES** \_\_\_\_\_ **NO** \_\_\_\_\_ **N/A** \_\_\_\_\_

If **YES** provide the following information in the space indicated below.

- a. What resources (staffing, maintenance, upgrades, etc.) are anticipated to be required to operate and maintain the proposed project?
- b. How will the proposed project offset the cost of operation and maintenance?
- c. Are there additional potential sources of economic benefit available?

*Click on gray area to insert response -box will expand as needed:*

**12. Is the proposed project supported by available or previously designated funding?**

**YES** \_\_\_\_\_ **NO** \_\_\_\_\_ **N/A** \_\_\_\_\_

If **YES** provide the following information in the space indicated below.

- a. What funding sources are designated for the proposed project?
- b. If the construction/acquisition of the proposed project is to be phased or otherwise completed over a period of 2 or more fiscal years, are the designated funds available for each fiscal year?

*Click on gray area to insert response -box will expand as needed:*

**13. Will construction/acquisition of the proposed project now result in significant savings or economies of scale?**

YES \_\_\_\_\_ NO \_\_\_\_\_ N/A \_\_\_\_\_

If YES provide the following information in the space indicated below.

- a. What are the anticipated costs to delaying the project?
- b. Are there factors other than inflation that may result in additional costs?

Click on gray area to insert response -box will expand as needed:

**14. Will the proposed project improve the efficiency of existing operations?**

YES \_\_\_\_\_ NO \_\_\_\_\_ N/A \_\_\_\_\_

If YES provide the following information in the space indicated below.

- a. What existing services will be impacted by the proposed project?
- b. In what way will the proposed project improve existing services?
- c. Are there options to the proposed project to gain similar improvements in efficiency?

Click on gray area to insert response -box will expand as needed:

**15. Will the proposed project require additional resources (staff, funding, etc.) to support its operation after completion?**

**YES** \_\_\_\_\_ **NO** \_\_\_\_\_ **N/A** \_\_\_\_\_

If **YES** provide the following information in the space indicated below.

- a. What additional resources will be required?
- b. Can some resources be 'shared' with other assets?
- c. Are there options available that will limit need for additional resources?

Click on gray area to insert response -box will expand as needed:

**16. Will the proposed project improve levels of service provided?**

**YES** \_\_\_\_\_ **NO** \_\_\_\_\_ **N/A** \_\_\_\_\_

If **YES** provide the following information in the space indicated below.

- a. What other asset or function will be enhanced by the proposed project?
- b. How will levels of service be enhanced?

Click on gray area to insert response -box will expand as needed:

**17. Does the proposed project coordinate well with other ongoing or planned projects?**

YES \_\_\_\_\_ NO \_\_\_\_\_ N/A \_\_\_\_\_

If YES provide the following information in the space indicated below.

- a. What other projects may be impacted by the decision to construct/acquire the proposed project at this time?
- b. Are there any special concerns that need to be addressed to ensure the development of the proposed project does not negatively impact other projects?

Click on gray area to insert response -box will expand as needed:

**18. Does the proposed project address needs or otherwise benefit other jurisdictions?**

YES \_\_\_\_\_ NO \_\_\_\_\_ N/A \_\_\_\_\_

If YES provide the following information in the space indicated below.

- a. What jurisdiction(s) will benefit from the proposed project?
- b. What are the potential benefits?
- c. Is there a potential for partnership with the jurisdiction?

Click on gray area to insert response -box will expand as needed:

19. Will the project create any disruption or inconvenience to the public?

YES \_\_\_\_\_ NO \_\_\_\_\_ N/A \_\_\_\_\_

If YES provide the following information in the space indicated below.

- a. What are the potential sources of disruption or inconvenience to the public?
- b. What steps can be taken to mitigate the problems?

Click on gray area to insert response -box will expand as needed:

*Town of Salem*  
**NORTHERN OCONEE**  
**ECONOMIC DEVELOPMENT PROJECT**

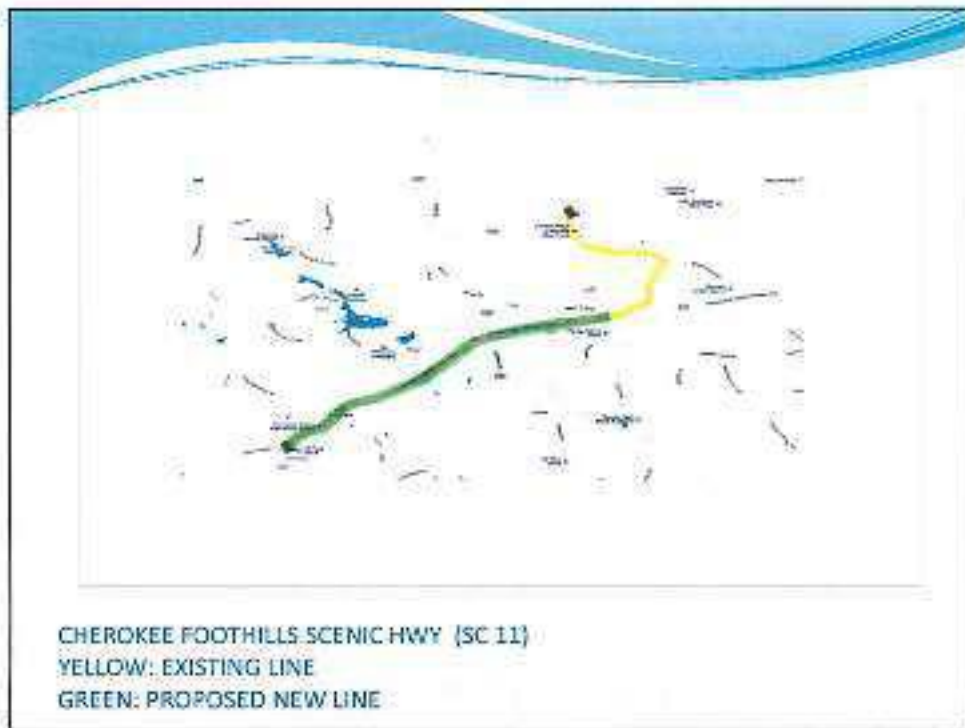





## SALEM IS OPEN TO PARTNERSHIPS

**Oconee County  
Comprehensive  
Plan:**

**Strategies for  
success :**

## SALEM IS OPEN TO PARTNERSHIPS

**Oconee County  
Comprehensive  
Plan:**

**Strategies for  
success :**

**Emergency  
Services - ISO  
Rating**



### COST ESTIMATE

#### WATER LINE EXTENSIONS (Hwy 11 and 130 Business Corridor)

- 27,456 LF 8" DIP @ \$33.54
- (21,648' Hwy 11) + (5,808 Hwy 130)  
\$920,874.24
- 8" valves, Tees, MJ bends, Hydrants, Jack/Boar
- ARV, PRV with bypass, concrete enclosure, Drive way repair,
- Re Grass, Silt Fence:  
\$148,640
- Pump Station (Park Ave)  
\$200,000
- Project Engineering:  
\$45,000
- Total:  
\$1,314,514.20

## BENEFITS OF INFRASTRUCTURE EXTENSION

- 175 TEMPORARY CONSTRUCTION JOBS
- 85 PERMANENT JOBS
- ENHANCES STANDARD OF LIVING FOR COMMUNITY
- IMPROVES FIRE SAFETY
- OPENS THE DOOR FOR FUTURE BUSINESS AND RESIDENTIAL GROWTH



NORTHERN OCONEE COUNTY ECONOMIC BUSINESS OPPORTUNITIES



**OCONEE COUNTY  
CAPITAL PROJECT SALES TAX COMMISSION**

Council Chambers, Oconee County Administrative Offices  
415 South Pine Street, Walhalla, SC

**PROJECT SUBMITTAL FORM**

**Due no later than January 15, 2014**

The Capital Project Sales Tax Commission has established a minimum project value for submission in the amount of \$250,000.

1. **PROJECT NAME:** RECREATION & SENIOR CENTER

2. **Entity Name:** TOWN OF SALEM

3. **\*\*Project Description:** Gym, Activity center with exercise facility and educational rooms. Ball fields walking trails etc. benefit To all ages. Youth – Senior.

4. **Estimated Project Cost:** \$ 743,700.00

5. **Funding for this project from other source[s]:** (\$ 75,000.00 )  
Town Match

6. **Net Amount Applied For:** \$ 736,200.00

7. **\*\*Benefits of Project:** The Quality of life in the Town and surrounding Area

8. **Entity Contact Information:**  
Name: Town of Salem  
Telephone Number[s]: 864-944-2819  
Email: kalexander@salemsc.us

9. **Submitted by [name/title]:** Kim Alexander, Clerk

10. **Other Comments/Notes:** Please see attached.

\*\* You may provide supporting material with this form to include but not limited to plans, studies, maps, brochures, artist renderings, cost estimates, photographs, etc. Submitted material should not exceed 20 pages [in addition to this form].

Please be advised that the Commission may (for the Commission's discretion) schedule a meeting with the Entity submitting the project to obtain additional information.

Questions regarding this process and/or this form should be directed to [shulse@oconeesc.com](mailto:shulse@oconeesc.com)

<u>COMMISSION USE</u>
CPSTC ID# II
Date Rec'd: 1-15-14
Recommended: Y / N



Oconee County, South Carolina

**Capital Project Sales Tax Commission  
Project Criteria Questionnaire**

Project Name/Description: RECREATION & SENIOR CENTER

The purpose of this document is to assist the Capital Project Sales Tax Commission (CPSTC) in understanding your proposed capital projects.

**Please provide a brief summary of the overall project below:**

The park recreation facility and community senior center will serve the purpose of simple relaxation and gathering with family and friends for picnics with the average Oconee County Resident will visit a park at least once per month for picnics and/or exercise along with other types of recreational activities. Festivals and fairs are other popular events for small towns during the warmer months. Moreover, festivals can be excellent economic development tools, yielding a \$4 in local sales for every \$1 spent on organizing the festival and often Town parks are the setting. This facility will serve approximately 93% of the senior population in the county as they are in close proximity to the location of this facility. Added senior activities and continuing ed class will help improve the quality of life for the residents in Northern Oconee County.

The purpose of this questionnaire is to gather additional information regarding the project. Please provide as much information as you wish for each question. The Commission is not requesting that you provide any information not already in your possession regarding this project.

**SUBMISSION OF THIS FORM:**

Please return this form to the staff liaison either via email or US Mail:

[bhulse@oconeesc.com](mailto:bhulse@oconeesc.com)

Clerk to Council  
Oconee County Administrative Offices  
415 South Pine Street  
Walhalla, SC 29691

Please be advised that individual Commission members will not accept questionnaires.

**1. Does the proposed project directly address a health and/or safety needs in Oconee County?**

YES  NO  N/A

If YES provide the following information in the space indicated below.

- a. What is the need most directly addressed by the proposed project, and how will it address the issue?
- b. Are there other possible alternatives to proposed project?
- c. Have other solutions been proposed/attempted?
- d. What secondary benefits to health and safety will result from the proposed project?

Click on gray area to insert response -box will expand as needed:

Benefits identified were as follows: •Personal Benefits: •Exercise, fitness & conditioning , Fun and entertainment, Learning and education , Relaxation ,Health, Social Benefits: Getting to know people, Group participation, Interaction of adults and kids, Community awareness ,Environmental Benefits: Fresh air, Nature, A place to be outdoors

**2. Does the proposed project address a federal/state mandate?**

YES  NO  N/A

If YES provide the following information in the space indicated below.

- a. What agency is mandating the project (note specific section of law/regulation)?
- b. Has the project been reviewed by an attorney, and if so who?
- c. Are there other possible alternatives to the proposed project?
- d. Is there a deadline to meet the mandate, and is this a recurring requirement? If so, what is the anticipated length of time the proposed project will remain in compliance?

Click on gray area to insert response -box will expand as needed:

**3. Is the proposed project consistent with adopted strategic plans for either the county or one or more of the municipalities?**

YES  NO  N/A

If **YES** provide the following information in the space indicated below.

- a. What strategic plans reference the proposed project (note any timelines, responsible parties, etc.)?
- b. What agency sponsored the strategic plan?
- c. How was the plan developed?
- d. Has the plan been adopted/endorsed by County Council, City Council or other governing bodies?

Click on gray area to insert response -box will expand as needed:

The County has a strategic plan that includes this information.

**4. Does the proposed project implement the recommendations of a previous study?**

YES  NO  N/A

If **YES** provide the following information in the space indicated below.

- a. What agency sponsored the study (note the source of any funding)?
- b. What was the purpose of the study, and when was it performed?
- c. What factors considered in the study have changed since the work was done?
- d. Have the results of the study been presented to County Council?

Click on gray area to insert response -box will expand as needed:



**5. Has the proposed project been included in previous Capital Improvement Plans for the County or another organization?**

YES \_\_\_\_\_ NO  N/A \_\_\_\_\_

If YES provide the following information in the space indicated below.

- a. When was the project first proposed?
- b. What was the original proposed date of construction/acquisition/implementation?
- c. Has any other agency also included the proposed project (or significant portion of) on their capital improvement plan?

*Click on gray area to insert response -box will expand as needed:*

**6. Will the proposed project result in the creation of (or retention of) jobs?**

YES  NO \_\_\_\_\_ N/A \_\_\_\_\_

If YES provide the following information in the space indicated below.

- a. How many jobs will be created?
- b. How many jobs will be retained that would otherwise be lost without the proposed project?
- c. What types of jobs?
- d. What is that anticipated pay range of the jobs?
- e. Are there other known job-related benefits associated with the proposed project?

*Click on gray area to insert response -box will expand as needed:*

Park workers that will be employed by the town along with business that will benefit from the tournaments and other events this will bring.

**7. Will the proposed project facilitate development that directly enhances revenues through taxes or fees?**

YES  NO  N/A

If YES provide the following information in the space indicated below.

- a. What sources of increased revenues (taxes, fees, etc.) are anticipated to stem from the proposed project?
- b. What is the anticipated annual impact on each revenue source?
- c. Are there other possible enhancements to revenues that may be associated with the proposed project?

Click on gray area to insert response -box will expand as needed:

We have an economic numbers and a study .

**8. Will the proposed project enhance the County's image, thereby attracting potential investors?**

YES  NO  N/A

If YES provide the following information in the space indicated below.

- a. How will the proposed project be viewed by the 'average' citizen?
- b. How 'visible' will the proposed project (or its benefits) be?
- c. What type(s) of, and how much, private investment is the proposed project anticipated to attract?
- d. What level and type of promoting will be necessary to achieve the proposed project's maximum potential in attracting investment?

Click on gray area to insert response -box will expand as needed:

Attract more business

**9. Will the proposed project help prevent the loss of jobs and/or revenue (other than any discussed above in this section) from Oconee County?**

YES  NO  N/A

If YES provide the following information in the space indicated below.

- a. What types of jobs/revenue are subject to loss without the proposed project?
- b. Has a project similar to the one proposed been completed in the county/jurisdiction to which the jobs/revenue will potentially be lost? If so, describe.
- c. Are there known alternatives to the proposed project that may effectively save the jobs/revenue?

Click on gray area to insert response -box will expand as needed:

**10. Will the proposed project facilitate acquisition of grants and/or other outside funding?**

YES  NO  N/A

If YES provide the following information in the space indicated below.

- a. What types of grants and/or other outside funding sources are expected to be made available by construction/acquisition of the proposed project?
- b. Have other jurisdictions successfully leveraged such funds with similar projects? If so, provide a brief overview.

Click on gray area to insert response -box will expand as needed:

**11. Will the project be economically sustainable?**

YES  NO  N/A

If **YES** provide the following information in the space indicated below.

- a. What resources (staffing, maintenance, upgrades, etc.) are anticipated to be required to operate and maintain the proposed project?
- b. How will the proposed project offset the cost of operation and maintenance?
- c. Are there additional potential sources of economic benefit available?

*Click on gray area to insert response -box will expand as needed:*

**12. Is the proposed project supported by available or previously designated funding?**

YES  NO  N/A

If **YES** provide the following information in the space indicated below.

- a. What funding sources are designated for the proposed project?
- b. If the construction/acquisition of the proposed project is to be phased or otherwise completed over a period of 2 or more fiscal years, are the designated funds available for each fiscal year?

*Click on gray area to insert response -box will expand as needed:*

**13. Will construction/acquisition of the proposed project now result in significant savings or economies of scale?**

**YES**  **NO**  **N/A**

If **YES** provide the following information in the space indicated below.

- a. What are the anticipated costs to delaying the project?
- b. Are there factors other than inflation that may result in additional costs?

Click on gray area to insert response -box will expand as needed:

**14. Will the proposed project improve the efficiency of existing operations?**

**YES**  **NO**  **N/A**

If **YES** provide the following information in the space indicated below.

- a. What existing services will be impacted by the proposed project?
- b. In what way will the proposed project improve existing services?
- c. Are there options to the proposed project to gain similar improvements in efficiency?

Click on gray area to insert response -box will expand as needed:

**15. Will the proposed project require additional resources (staff, funding, etc.) to support its operation after completion?**

YES  NO  N/A

If YES provide the following information in the space indicated below.

- a. What additional resources will be required?
- b. Can some resources be 'shared' with other assets?
- c. Are there options available that will limit need for additional resources?

Click on gray area to insert response -box will expand as needed:

**16. Will the proposed project improve levels of service provided?**

YES  NO  N/A

If YES provide the following information in the space indicated below.

- a. What other asset or function will be enhanced by the proposed project?
- b. How will levels of service be enhanced?

Click on gray area to insert response -box will expand as needed:

**17. Does the proposed project coordinate well with other ongoing or planned projects?**

YES  \_\_\_\_\_ NO \_\_\_\_\_ N/A \_\_\_\_\_

If YES provide the following information in the space indicated below.

- What other projects may be impacted by the decision to construct/acquire the proposed project at this time?
- Are there any special concerns that need to be addressed to ensure the development of the proposed project does not negatively impact other projects?

**18. Does the proposed project address needs or otherwise benefit other jurisdictions?**

YES  \_\_\_\_\_ NO \_\_\_\_\_ N/A \_\_\_\_\_

If YES provide the following information in the space indicated below:

- What jurisdiction(s) will benefit from the proposed project?
- What are the potential benefits?
- Is there a potential for partnership with the jurisdiction?

This will help with the county wide recreation needs Basic services to poorer residents  
Protection of natural environment  
Civic identity and pride  
Community visual appeal and function  
Develops strong communities  
Percent of population using regularly  
Individual growth and development  
Avoidance of costly damage due to mismanagement of the ecological system  
Prevents social problems  
Reduces health problems and costs  
Integrates disabled, disadvantaged and socially alienated  
Job creation  
Percent of population who might use  
Assists tourist industry  
Attracts industry  
Prepares individual to cooperate with others  
Increases property values and tax revenues  
Opportunities for underemployed  
Desire to replace volunteer effort  
Saves property owner expense  
Stimulates leisure retail industry

**19. Will the project create any disruption or inconvenience to the public?**

YES \_\_\_\_\_ NO   x   N/A \_\_\_\_\_

If YES provide the following information in the space indicated below.

- a. What are the potential sources of disruption or inconvenience to the public?
- b. What steps can be taken to mitigate the problems?

Click on gray area to insert response -box will expand as needed:



# TAMASSEE-SALEM RECREATION & SENIOR CENTER PROJECT

TOWN OF SALEM & T.S. Recreation

## SURVEYS

- ▶ SENT BY MAIL AND HANDED OUT AT RECREATION FUNCTIONS AND TOWN HALL
- ▶ TOTAL 1223
- ▶ RETURNED 278
- ▶ YES 261
- ▶ NO 17

## SURVEY ANSWERS

- ▶ MEAN AGE 43
- ▶ MALE AND FEMALE PARTICIPANTS
- ▶ USE OF FACILITY 80% WEEKLY
- ▶ USE EXERCISE (INDOOR WALKING TRACK)
- ▶ OUTDOOR USE WALKING TRAIL
- ▶ SUPPORTERS OF THE FACILITY REQUESTED WORKOUT FACILITY, ACTIVITIES FOR SENIORS 60+, BINGO, YOGA, DANCE, EQUESTRIAN EVENTS, TRAINING FACILITY & MEETING SPACE (GED)

## FACILITIES TO INCLUDE

- ▶ GYMNASIUM
- ▶ WALKING TRACK INDOOR
- ▶ WORKOUT FACILITY
- ▶ MEETING SPACE
- ▶ AEROBICS
- ▶ YOGA
- ▶ BASKETBALL
- ▶ VOLLEYBALL

## GYMNASIUM

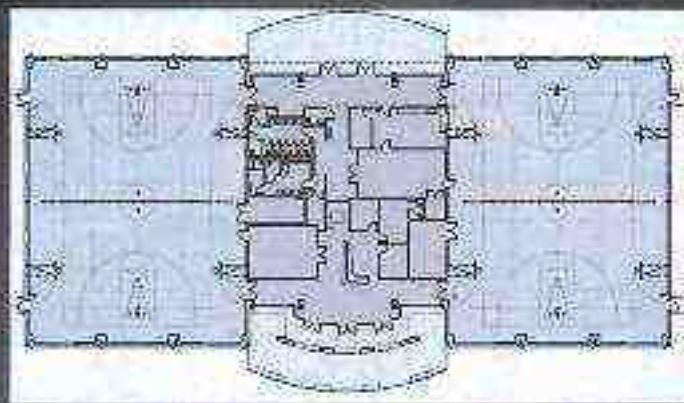

## INDOOR WALKING TRACK



## INDOOR OPTIONS



## OUTSIDE DESIGN OPTIONS



## OUTSIDE DESIGN OPTIONS



## OUTDOOR FACILITIES

- ▶ BALL FIELDS
- ▶ BASEBALL
- ▶ SOFTBALL
- ▶ SOCCER
- ▶ WALKING TRAILS
- ▶ BIKING TRAILS

## OUTDOOR OPTIONS



## BASEBALL & SOFTBALL FIELD



## BATTING CAGES



## WALKING & BIKING TRAILS



## GROWTH IN RECREATION PAST YEARS

2007-56 TO 2013 = 136



## ACCOMPLISHMENTS

**Congratulations!** Canada's Youth Recreation Department  
1st World Cup Recreational Team  
1st World Cup Recreational Team

**Provincials by Team:**  
Trenton, Ontario  
Trenton, Ontario  
Trenton, Ontario

**2013 World Cup Recreational Team**  
The 2013 World Cup Recreational Team is a group of 12 athletes from across the province who have been selected to represent Ontario at the World Cup Recreational Team in 2013.



## SPORT CAMPS



## PROJECTED COST

- ▶ TOTAL REQUESTED \$734,700.00
- ▶ TOTAL MATCH \$75,000.00
- ▶ TOTAL ESTIMATED PROJECT \$736,200.00
- ▶ LAND PURCHASE \$75,000.00
- ▶ CONTRACTOR ESTIMATES \$50.00/SQ. FT.
- ▶ ESTIMATED 14,000 SQ. FT FACILITY

## PARTNERSHIPS

- > SENIOR SOLUTIONS
- > GEO
- > LIBRARY BOARD
- > OCCONEE COLONY
- > MEALS ON WHEELS
- > TRAINING FOR JOBS & VOLUNTEER ORGANIZATIONS
- > AFTER SCHOOL PROGRAM
- > RED CROSS SHELTER



**OCCONEE COUNTY  
CAPITAL PROJECT SALES TAX COMMISSION**

Council Chambers, Oconee County Administrative Offices  
415 South Pine Street, Walhalla, SC

**PROJECT SUBMITTAL FORM**

**Due no later than January 15, 2014**

The Capital Project Sales Tax Commission has established a minimum project value for submission in the amount of \$250,000.

1.	<b>PROJECT NAME:</b>	City of Walhalla Water Plant Upgrades
2.	<b>Entity Name:</b>	City of Walhalla
3.	<b>**Project Description:</b>	Sludge processing upgrades to comply with SCDHEC regulation
4.	<b>Estimated Project Cost:</b>	\$500,000.00
5.	<b>Funding for this project from other source[s]:</b>	(\$250,000.00 ) City of Walhalla Utilities
6.	<b>Net Amount Applied For:</b>	\$250,000.00
7.	<b>**Benefits of Project:</b>	Water quality, and potential for industrial and residential growth
8.	<b>Entity Contact Information:</b>	
	<b>Name:</b>	Scott Parris
	<b>Telephone Number[s]:</b>	864-638-4343
	<b>Email:</b>	walhallowaterdep@bellsouth.net
9.	<b>Submitted by [name/title]:</b>	Nancy Goehle, City Administrator
10.	<b>Other Comments/Notes:</b>	

\*\*You may provide supporting material with this form to include but not limited to plans, studies, maps, brochures, artist renderings, cost estimates, photographs, etc. Submitted material should not exceed 20 pages *[in addition to this form]*.

Please be advised that the Commission may *for the County's discretion* schedule a meeting with the Entity submitting the project to obtain additional information.

Questions regarding this process and/or this form should be directed to [paulse@oconeese.com](mailto:paulse@oconeese.com).

<u>COMMISSION USE:</u>
CPSTC ID# <b>3</b>
Date Rec'd: <u>12/23/13</u>
Recommended: <u>Y / N</u>



Oconee County, South Carolina

**Capital Project Sales Tax Commission  
Project Criteria Questionnaire**

Project Name/Description: City of Walhalla Water Plant Upgrades

The purpose of this document is to assist the Capital Project Sales Tax Commission (CPSTC) in understanding your proposed capital projects.

**Please provide a brief summary of the overall project below:**

To provide upgrades to the existed Coneross Water Treatment Plant sludge handling process to help maintain compliance with SCDHEC regulations.

If additional monies remain after the upgrades to the Water Plant, it will be used for Walhalla Recreational ballfields.

The purpose of this questionnaire is to gather additional information regarding the project. Please provide as much information as you wish for each question. The Commission is not requesting that you provide any information not already in your possession regarding this project.

**SUBMISSION OF THIS FORM:**

Please return this form to the staff liaison either via email or USMail:

[bhulse@oconeesc.com](mailto:bhulse@oconeesc.com)

Clerk to Council  
Oconee County Administrative Offices  
415 South Pine Street  
Walhalla, SC 29691

Please be advised that individual Commission members will not accept questionnaires.

**1. Does the proposed project directly address a health and/or safety needs in Oconee County?**

YES  NO  N/A

If YES provide the following information in the space indicated below.

- a. What is the need most directly addressed by the proposed project, and how will it address the issue? Potable water supply
- b. Are there other possible alternatives to proposed project? no
- c. Have other solutions been proposed/attempted? yes
- d. What secondary benefits to health and safety will result from the proposed project? Safe water supply for citizens of Walhalla Water service area

Click on gray area to insert response -box will expand as needed:

**2. Does the proposed project address a federal/state mandate?**

YES  NO  N/A

If YES provide the following information in the space indicated below.

- a. What agency is mandating the project (note specific section of law/regulation)?SCDHEC
- b. Has the project been reviewed by an attorney, and if so who? No
- c. Are there other possible alternatives to the proposed project? No
- d. Is there a deadline to meet the mandate, and is this a recurring requirement? If so, what is the anticipated length of time the proposed project will remain in compliance? No

Click on gray area to insert response -box will expand as needed:

**3. Is the proposed project consistent with adopted strategic plans for either the county of one or more of the municipalities?**

YES  NO  N/A

If YES provide the following information in the space indicated below.

- a. What strategic plans reference the proposed project (note any timelines, responsible parties, etc.)? SCDHEC guidelines
- b. What agency sponsored the strategic plan? SCDHEC
- c. How was the plan developed? After an inspection to the site
- d. Has the plan been adopted/endorsed by County Council, City Council or other governing bodies? yes

Click on gray area to insert response -box will expand as needed:

**4. Does the proposed project implement the recommendations of a previous study?**

YES  NO  N/A

If YES provide the following information in the space indicated below.

- a. What agency sponsored the study (note the source of any funding)?
- b. What was the purpose of the study, and when was it performed?
- c. What factors considered in the study have changed since the work was done?
- d. Have the results of the study been presented to County Council?

Click on gray area to insert response -box will expand as needed:

**5. Has the proposed project been included in previous Capital Improvement Plans for the County or another organization?**

YES \_\_\_\_\_ NO  N/A \_\_\_\_\_

If YES provide the following information in the space indicated below.

- a. When was the project first proposed?
- b. What was the original proposed date of construction/acquisition/implementation?
- c. Has any other agency also included the proposed project (or significant portion of) on their capital improvement plan?

*Click on gray area to insert response -box will expand as needed:*

**6. Will the proposed project result in the creation of (or retention of) jobs?**

YES  NO \_\_\_\_\_ N/A \_\_\_\_\_

If YES provide the following information in the space indicated below.

- a. How many jobs will be created? Possibility of 5
- b. How many jobs will be retained that would otherwise be lost without the proposed project? 4
- c. What types of jobs? Water treatment operators and construction workers
- d. What is that anticipated pay range of the jobs? \$25,000 - \$65,000
- e. Are there other known job-related benefits associated with the proposed project?

N/A

*Click on gray area to insert response -box will expand as needed:*

**7. Will the proposed project facilitate development that directly enhances revenues through taxes or fees?**

YES  NO  N/A

If **YES** provide the following information in the space indicated below.

- What sources of increased revenues (taxes, fees, etc.) are anticipated to stem from the proposed project? Water fees, industrial growth & residential growth
- What is the anticipated annual impact on each revenue source? Unknown
- Are there other possible enhancements to revenues that may be associated with the proposed project? No

Click on gray area to insert response -box will expand as needed:

**8. Will the proposed project enhance the County's image, thereby attracting potential investors?**

YES  NO  N/A

If **YES** provide the following information in the space indicated below.

- How will the proposed project be viewed by the 'average' citizen? Better water supply
- How 'visible' will the proposed project (or its benefits) be? Seen by each water customer
- What type(s) of, and how much, private investment is the proposed project anticipated to attract? unknown
- What level and type of promoting will be necessary to achieve the proposed project's maximum potential in attracting investment? Will be up to the County Economic Development

Click on gray area to insert response -box will expand as needed:



**9. Will the proposed project help prevent the loss of jobs and/or revenue (other than any discussed above in this section) from Oconee County?**

YES \_\_\_\_\_ NO  N/A \_\_\_\_\_

If YES provide the following information in the space indicated below.

- a. What types of jobs/revenue are subject to loss without the proposed project?
- b. Has a project similar to the one proposed been completed in the county/jurisdiction to which the jobs/revenue will potentially be lost? If so, describe.
- c. Are there known alternatives to the proposed project that may effectively save the jobs/revenue?

Click on gray area to insert response -box will expand as needed:

**10. Will the proposed project facilitate acquisition of grants and/or other outside funding?**

YES \_\_\_\_\_ NO  N/A \_\_\_\_\_

If YES provide the following information in the space indicated below.

- a. What types of grants and/or other outside funding sources are expected to be made available by construction/acquisition of the proposed project?
- b. Have other jurisdictions successfully leveraged such funds with similar projects? If so, provide a brief overview.

Click on gray area to insert response -box will expand as needed:

**11. Will the project be economically sustainable?**

YES  NO  N/A

If YES provide the following information in the space indicated below.

- a. What resources (staffing, maintenance, upgrades, etc.) are anticipated to be required to operate and maintain the proposed project? Already have 4 employees on staff
- b. How will the proposed project offset the cost of operation and maintenance? It will lower operating cost and repair
- c. Are there additional potential sources of economic benefit available? Added residential and industrial growth

*Click on gray area to insert response -box will expand as needed:*

**12. Is the proposed project supported by available or previously designated funding?**

YES  NO  N/A

If YES provide the following information in the space indicated below.

- a. What funding sources are designated for the proposed project?
- b. If the construction/acquisition of the proposed project is to be phased or otherwise completed over a period of 2 or more fiscal years, are the designated funds available for each fiscal year?

*Click on gray area to insert response -box will expand as needed:*

**13. Will construction/acquisition of the proposed project now result in significant savings or economies of scale?**

YES  NO  N/A

If YES provide the following information in the space indicated below.

- a. What are the anticipated costs to delaying the project? Potential fines
- b. Are there factors other than inflation that may result in additional costs? no

Click on gray area to insert response -box will expand as needed:

**14. Will the proposed project improve the efficiency of existing operations?**

YES  NO  N/A

If YES provide the following information in the space indicated below.

- a. What existing services will be impacted by the proposed project? Water production
- b. In what way will the proposed project improve existing services? Water quality
- c. Are there options to the proposed project to gain similar improvements in efficiency? N/A

Click on gray area to insert response -box will expand as needed:

**15. Will the proposed project require additional resources (staff, funding, etc.) to support its operation after completion?**

YES \_\_\_\_\_ NO  N/A \_\_\_\_\_

If YES provide the following information in the space indicated below.

- a. What additional resources will be required?
- b. Can some resources be 'shared' with other assets?
- c. Are there options available that will limit need for additional resources?

Click on gray area to insert response -box will expand as needed:

**16. Will the proposed project improve levels of service provided?**

YES  NO \_\_\_\_\_ N/A \_\_\_\_\_

If YES provide the following information in the space indicated below.

- a. What other asset or function will be enhanced by the proposed project? Plant Operations.
- b. How will levels of service be enhanced? Ease of operations

Click on gray area to insert response -box will expand as needed:

**17. Does the proposed project coordinate well with other ongoing or planned projects?**

YES  NO  N/A

If YES provide the following information in the space indicated below.

- a. What other projects may be impacted by the decision to construct/acquire the proposed project at this time? Complete Water Plant Upgrade
- b. Are there any special concerns that need to be addressed to ensure the development of the proposed project does not negatively impact other projects?  
No

Click on gray area to insert response -box will expand as needed:

**18. Does the proposed project address needs or otherwise benefit other jurisdictions?**

YES  NO  N/A

If YES provide the following information in the space indicated below.

- a. What jurisdiction(s) will benefit from the proposed project? Oconee County
- b. What are the potential benefits? Growth and Tax revenue
- c. Is there a potential for partnership with the jurisdiction? No

Click on gray area to insert response -box will expand as needed:

**19. Will the project create any disruption or inconvenience to the public?**

**YES** \_\_\_\_\_ **NO**  **N/A** \_\_\_\_\_

If **YES** provide the following information in the space indicated below.

- a. What are the potential sources of disruption or inconvenience to the public?
- b. What steps can be taken to mitigate the problems?

Click on gray area to insert response -box will expand as needed:

***Capital Project Sales Tax Commission***  
***March – April Meeting Schedule***

Monday, March 10, 2014           ~ Additional Meeting with Entities to address any questions/concerns  
[at this meeting you could also allow time for the public to ask questions]

---

Thursday, March 13, 2014       ~ Public Comment Meeting regarding 10 Potential Projects

---

Thursday, March 20, 2014      ~ Final Project Presentation Scoring Review & Discussion

---

Thursday, March 27, 2014      ~ Final Discussion & Adoption of Final Project List  
for Council Consideration

---

Thursday, April 10, 2014       ~ Administrator & Finance Director's presentation to the Commission  
regarding Potential Funding Options Commission Discussion & ~  
~ Recommendation for Council re: Funding

---

Tuesday, APRIL 15, 2014       ~ COMMISSION PRESENTATION TO COUNTY COUNCIL  
WITH FINAL PROJECT LIST AND FUNDING  
RECOMMENDATION

---

# Proposed Timeline with Critical Dates

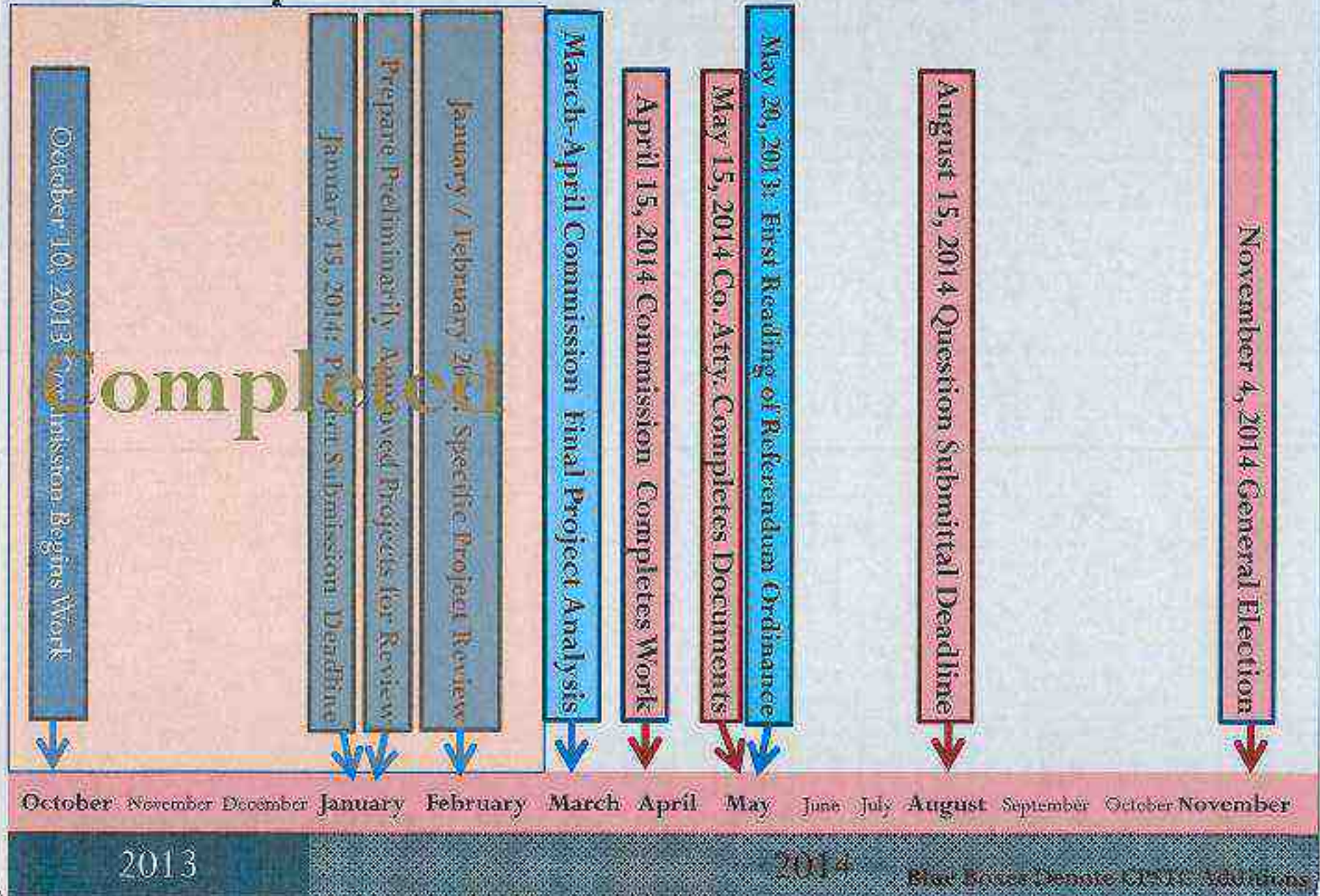



**PUBLISHER'S AFFIDAVIT**

STATE OF SOUTH CAROLINA  
COUNTY OF OCONEE

OCONEE COUNTY COUNCIL

IN RE: Project Sales Tax Commission Meeting 2/19/14

BEFORE ME the undersigned, a Notary Public for the State and County above named, This day personally came before me, Hal Welch, who being first duly sworn according to law, says that he is the General Manager of **THE JOURNAL**, a newspaper published Tuesday through Saturday in Seneca, SC and distributed in Oconee County, Pickens County and the Pendleton area of Anderson County and the notice (of which the annexed is a true copy) was inserted in said papers on 01/18/2014 and the rate charged therefore is not in excess of the regular rates charged private individuals for similar insertions.

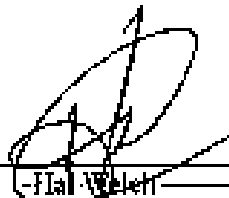

Hal Welch  
General Manager

Subscribed and sworn to before me this  
01/18/2014



Jennifer A. White  
Notary Public for South Carolina  
My commission Expires: 05/18/2014

## LEGAL NOTICES

## LEGALS

2008. Although these letters appear to be directed to our district, they are useful to the parents of former students in applying for Social Security benefits, resolving college entrance issues or so student, parent or guardian responds to this lettering notice in the newspaper. A notice on the SOCC of a school district will assure the county special education office specific to this student, as parent, student or parent of a disabled student may be records in writing or in person.

SOCC Special Education Department/Room 202  
444 S. Pine Street  
Methuen, NC 28881

We appreciate your assistance in picking up records in a timely manner. The request has been processed. This notice is in compliance with federal regulations CFR 300.610 related to students with disabilities receiving special education. If you do not understand or if you do need more information, contact our office (864) 899-9145.

STATE OF SOUTH CAROLINA  
COUNTY OF GOOCH  
IN THE COURT OF COMMON PLEAS

CASE NO. 2013-CP-27304  
NOTICE OF SALE

Community First Bank, Inc.  
PLAINTIFF,

VS.  
Jonathan M. Dixonson,  
Gooch County Delinquent Collector  
DEFENDANTS.

Pursuant to the Decree of the Court of Common Pleas for the County, South Carolina in the Community First Bank, Jonathan M. Dixonson vs. Gooch County Delinquent Collector, dated January 16, 2014, will set the following described real estate before the Court for Sale on February 20, 2014, the same being February 3, 2014 at 11:00 a.m.

All that certain piece, parcel of land situated, lying and being in the State of South Carolina, Gooch County, being known and designated as Tract B, containing ACRE, more or less, as more particularly described on a plat by Stephen A. Edwards, A-19881, recorded in Plat Book Page 10, records of Gooch County, South Carolina.

AND ALSO: A non-exclusive and right of way for ingress and egress to the aforementioned parcel over the present existing driveway and also a non-exclusive right of way to lay, construct, maintain the existing water line, the gravel driveway and water piping in a nearby direction.

Worthover Highway to Tract A, AND ALSO: One 1995 Fleet Model Home, Vehicle ANFLW41468970113, which been permanently under a lien offered to the aforementioned estate on Tract B and bearing internal fixture and piece and part of Tract B.

This conveyance is made subject any and all assessments or liens, any restrictive covenants by, through, behalf or any predecessor title may appear of public record upon the premises.

## LEGAL NOTICES

## LEGALS

stamp.  
Beverly L. Whitfield,  
Clerk of Court for Gooch County  
January 17, 2014  
Gooch County, South Carolina

STATE OF  
SOUTH CAROLINA  
COUNTY OF GOOCH  
IN THE COURT OF  
COMMON PLEAS  
CASE NO. 2013-CP-27304  
NOTICE OF SALE

Community First Bank, Inc.  
PLAINTIFF,

VS.  
Tanya L. Baldwin, and the Gooch  
County Delinquent Tax Collector  
DEFENDANTS.

Pursuant to the Decree of the Court of Common Pleas for Gooch County, South Carolina in the case of Community First Bank, Inc. vs. Tanya L. Baldwin and the Gooch County Delinquent Tax Collector dated January 16, 2014, will set the following described real estate before the Court for Sale on February 20, 2014, the same being February 3, 2014 at 11:00 a.m.

All that certain piece, parcel of land and being situated in the State of South Carolina, County of Gooch, containing 1.01 acres, more or less, as shown and designated upon a plat of survey prepared by Terry L. Eades, PLS #10018, dated May 11, 2000 and recorded in Plat Book P-62, at Page 295, records of Gooch County, South Carolina. This being the identical property conveyed into Tanya L. Baldwin by deed of Lathan Properties, Inc. dated August 24, 2006 and recorded in Deed Book 1887, at Page 28, records of Gooch County, South Carolina.

TMS 1993-00-12-011.  
The sale shall be subject to taxes and assessments, existing encumbrances and restrictions of record, and any other conditions, covenants, and restrictions.

As delinquent, a redemption bidding will remain open for 90 days.

The successful bidder at the sale, if other than the Plaintiff, shall be required to make a cash deposit of

## LEGAL NOTICES

## LEGALS

two (2%) percent of the bid as evidence of good faith in bidding, which sum shall be retained in the event of non-compliance with the terms of the bid within thirty (30) days, and be applied to the costs of this action and the sale, and to the Plaintiff's judgment, and if the highest and best bidder shall fail to comply, the Clerk of Court may declare the next highest bidder the successful one or she may re-advertise and sell the property again under the terms of some subsequent Sales Day.

compliance with the terms of the bid. Clerk of Court shall execute and deliver a deed of conveyance to the successful purchaser, giving said purchaser the right of possession.

The mortgage described by the deed and the right of equity of Defendant shall be forever waived and all persons claiming through or under them forever barred of all right, title, ten, claim and equity in such premises or any part thereof.

TERMS OF SALE: CASH. Payment to pay extra for deed and stamp.

Beverly L. Whitfield  
Clerk of Court  
for Gooch County  
January 17, 2014  
Gooch County, South Carolina

The Gooch County Capital Project Sales Tax Commission will hold a meeting on Wednesday, February 19, 2014 9:30 a.m. in Council Chambers, Gooch County Administration Office, 444 S. Pine Street, Methuen, SC.

Get News  
Quick with  
The Journal  
Call  
Today!



Find your new  
best friend in  
The Journal

## SERVICE FINDER

BEST LOCAL SERVICE PROFESSIONALS

## CLEANING

Cesar's  
Professional

- Painting
- Pressure Washing
- Deck & Bark Treatments
- Window Cleaning
- Carpet Cleaning
- Gutter & Roof Cleaning
- Windows & Siding Cleaning
- Soft Cleaning

Residential & Commercial  
Licensed & Insured

10% off in business

## CLEANING

MARINA'S  
PROFESSIONAL  
WINDOW CLEANING

Specializing in  
Residential

BEST ANY  
REASONABLE  
PRICE

Talk to me  
Rocky Martin

## HOME IMPROVEMENT

J. Dalen  
Professional  
Building Services

CARPENTRY  
PLUMBING  
ELECTRICAL  
PAINTING

30 years experience  
HOME REPAIRS



## HOME IMPROVEMENT

GARRETT REPAIR  
& REMODELING

Service You Can Trust

20% Senior Discount

- Electrical
- Plumbing
- Carpentry
- Painting
- Handyman Services

Advertise your  
service here  
and online  
for \$105  
per four weeks!





Oconee County  
Council Office

T. Scott Moulder  
Administrator

Oconee County  
Administrative Offices  
415 South Pine Street  
Walhalla, SC 29691

Phone: 864-718-1023  
Fax: 864-718-1024

E-mail:  
[bluelines@oconee.org](mailto:bluelines@oconee.org)

Paul Corbett  
Vice Chairman  
District I

Wayne McCall  
District II

Archie Barron  
District III

Joel Hunt  
District IV  
Chairman

Reginald T. Dexter  
District V

.....LEGAL AD.....

**PLEASE ADVERTISE IN THE NEXT ISSUE  
OF YOUR NEWSPAPER**

The Oconee County Capital Project Sales Tax Commission will hold a meeting on Wednesday, February 19, 2014 6:30 p.m. in Council Chambers, Oconee County Administrative Offices, 415 S. Pine Street, Walhalla, SC.



**Beth Hulse**

---

**From:** Beth Hulse  
**Sent:** Friday, January 17, 2014 10:42 AM  
**To:** Beth Hulse; classadmgr@upstatetoday.com  
**Subject:** CPSTC 02-19-14  
**Attachments:** 011714 - CPSTC meeting 021914.doc

Please run at your earliest convenience.  
Thanks.

**Elizabeth G. Hulse**  
**Clerk to County Council**  
Oconee County Administrative Offices  
415 South Pine Street  
Walhalla, SC 29691  
864-718-1023  
864-718-1024 [fax]  
[bhulse@oconeesc.com](mailto:bhulse@oconeesc.com)  
[www.oconeesc.com/council](http://www.oconeesc.com/council)

**CONFIDENTIALITY NOTICE:** This e-mail message, including any attachments, is for the sole use of the intended recipient(s) and may contain confidential, proprietary, and/or privileged information protected by law. If you are not the intended recipient, you may not read, use, copy, or distribute this e-mail message or its attachments. If you believe you have received this e-mail message in error, please contact the sender by reply e-mail or telephone immediately and destroy all copies of the original message.

**Beth Hulse**

---

**From:** Beth Hulse  
**Sent:** Friday, January 17, 2014 10:43 AM  
**To:** Beth Hulse; Carlos Galarza; Chad Dorsett; DJM News Editor; Greenville News (localnews@greenvillenews.com); Kevin Norman Cannada (kcannada@upstatetoday.com); Ray Chandler; Westminster News / Keowee Courier (westnews@be1south.net); WGOG (dickmangrum@wgog.com); WSPA TV - Channel 7 (assignmentdesk@wspa.com)  
**Cc:** Brenda Davis; Don Fuller; Glen McPheeters; Mollie Smith; Russell Price; Thelma Miller  
**Subject:** Capital Project Sales Tax Commission - Meeting Notice

The Oconee County Capital Project Sales Tax Commission will hold a meeting on Wednesday, February 19, 2014 6:30 p.m. in Council Chambers, Oconee County Administrative Offices, 415 S. Pine Street, Walhalla, SC.

**Elizabeth G. Hulse**

**Clerk to County Council**

Oconee County Administrative Offices

415 South Pine Street

Walhalla, SC 29691

864-718-1023

864-718-1024 [fax]

[bhulse@oconeesc.com](mailto:bhulse@oconeesc.com)

[www.oconeesc.com/council](http://www.oconeesc.com/council)

**CONFIDENTIALITY NOTICE:** This e-mail message, including any attachments, is for the sole use of the intended recipient(s) and may contain confidential, proprietary, and/or privileged information protected by law. If you are not the intended recipient, you may not read, use, copy, or distribute this e-mail message or its attachments. If you believe you have received this e-mail message in error, please contact the sender by reply e-mail or telephone immediately and destroy all copies of the original message.